

Product information presented here reflects conditions at time of publication. Consult factory regarding discrepancies or inconsistencies.

*Quality Products  
Since 1866*

**MAIL TO:** 95 North Oak Street • Kendallville, IN 46755  
(260) 347-1600 • 1 (800) 345-9422 • FAX (260) 347-0909

## INSTALLATION INSTRUCTIONS

These installation instructions are applicable for Model 50TCPPC, ECP552PC, ECP752PC

### PRE INSTALLATION CHECKLIST - ALL INSTALLATIONS

1. **Inspect your pump.** Occasionally, products are damaged during shipment. If the unit is damaged, contact your dealer before using. **Do Not** remove the test plug in the cover.
2. **Carefully read the literature** provided to familiarize yourself with specific details regarding installation and use. These materials should be retained for future reference.



#### **▲ WARNING**

**SEE BELOW FOR LIST OF WARNINGS**

1. To reduce the risk of electric shock, install only a circuit protected by a ground-fault circuit-interruptor (GFCI). All pumps are furnished with provisions for proper grounding to help protect you against the possibility of electrical shock.
2. Make certain that the ground fault receptacle is within the reach of the pump's power supply cord **DO NOT USE AN EXTENSION CORD.** Extension cords that are too long or too light do not deliver sufficient voltage to the pump motor. But, more important, they could present a safety hazard if the insulation were to become damaged or the connection ends were to fall into the basin and become wet.
3. Make sure the pump electrical supply circuit is equipped with fuses or circuit breakers of proper capacity. A separate branch circuit is recommended, sized according to the National Electrical Code for the current shown on the pump name plate.
4. **TESTING FOR GROUND.** As a safety measure, each electrical outlet should be checked for ground using an Underwriters Laboratory Listed circuit analyzer which will indicate if the power, neutral and ground wires are correctly connected to your outlet. If they are not, call a qualified licensed electrician.
5. Installation and checking of electrical circuits and hardware should only be performed by a qualified licensed electrician.
6. **FOR YOUR PROTECTION, ALWAYS DISCONNECT PUMP FROM ITS POWER SOURCE BEFORE HANDLING.**
7. These pumps are supplied with a 3-prong grounded plug to help protect you against the possibility of electrical shock. **DO NOT UNDER ANY CIRCUMSTANCES REMOVE THE GROUND PIN.** The 3-prong plug must be inserted in a mating 3-prong fault interrupter receptacle. If the installation does not have such a receptacle, it must be changed to the proper type, wired, and grounded in accordance with the National Electrical Code and all applicable local codes and ordinances.
8. Risk of electric shock. This pump has not been investigated for use in swimming pool or marine areas.
9. According to the state of California (Prop 65), this product contains chemicals known to the state of California to cause cancer and birth defects or other reproductive harm.

#### **▲ CAUTION**

**SEE BELOW FOR LIST OF CAUTIONS**

1. Check to be sure your power source is capable of handling the voltage requirements of the motor, as indicated on the pump name plate.
  2. **Vent hole purpose.** It is advisable that all submersible sump pumps be of the bottom intake design to reduce clogging and seal failures. If a check valve is incorporated in the installation, a vent hole (approx. 3/16") must be drilled in the discharge pipe below the check valve and pit cover to purge the bottom intake unit of trapped air. Trapped air is caused by agitation and/or a dry basin. This vent hole should be checked periodically for clogging. Water stream will be visible from this hole during pump run periods.
  3. Maximum continuous operating water temperature for standard model pumps must not exceed 104°F (40°C).
- Note:** Pumps with the "cCSAus" mark are tested to UL Standard UL778 & CSA Standard C22.2 No. 108.

**DO NOT USE FOR PUMPING OILS,  
GASOLINE OR ANY PETROLEUM  
BY-PRODUCTS.**

**REFER TO WARRANTY ON PAGE 2.**

# LIMITED WARRANTY

This product is warranted for one year from the date of purchase or two years from the date of manufacture, whichever occurs first. Subject to the conditions hereinafter set forth, the manufacturer will repair or replace to the original consumer, any portion of the product which proves defective due to defective materials or workmanship. To obtain warranty service, contact the dealer from whom the product was purchased. The manufacturer retains the sole right and option to determine whether to repair or replace defective equipment, parts or components. Damage due to conditions beyond the control of the manufacturer is not covered by this warranty.

**THIS WARRANTY WILL NOT APPLY:** (a) To defects or malfunctions resulting from failure to properly install, operate or maintain the unit in accordance with printed instructions provided; (b) to failures resulting from abuse, accident or negligence or use of inappropriate chemicals or additives in the water; (c) to normal maintenance services and the parts used in connection with such service; (d) to units which are not installed in accordance with normal applicable local codes, ordinances and good trade practices; and (e) the unit is used for purposes other than for what it was designed and manufactured.

**RETURN OF WARRANTED COMPONENTS:** Any item to be repaired or replaced under this warranty must be returned to the manufacturer at Kendallville, Indiana or

such other place as the manufacturer may designate, freight prepaid.

**THE WARRANTY PROVIDED HEREIN IS IN LIEU OF ALL OTHER EXPRESS WARRANTIES, AND MAY NOT BE EXTENDED OR MODIFIED BY ANYONE. ANY IMPLIED WARRANTIES SHALL BE LIMITED TO THE PERIOD OF THE LIMITED WARRANTY AND THEREAFTER ALL SUCH IMPLIED WARRANTIES ARE DISCLAIMED AND EXCLUDED. THE MANUFACTURER SHALL NOT, UNDER ANY CIRCUMSTANCES, BE LIABLE FOR INCIDENTAL, CONSEQUENTIAL OR SPECIAL DAMAGES, SUCH AS, BUT NOT LIMITED TO DAMAGE TO, OR LOSS OF, OTHER PROPERTY OR EQUIPMENT, LOSS OF PROFITS, INCONVENIENCE, OR OTHER INCIDENTAL OR CONSEQUENTIAL DAMAGES OF ANY TYPE OR NATURE. THE LIABILITY OF THE MANUFACTURER SHALL NOT EXCEED THE PRICE OF THE PRODUCT UPON WHICH SUCH LIABILITY IS BASED.**

This warranty gives you specific legal rights, and you may have other rights which vary from state to state. Some states do not allow limitations on duration of implied warranties or exclusion of incidental or consequential damages, so the above limitations may not apply to you.

**In those instances where damages are incurred as a result of an alleged pump failure, the Homeowner must retain possession of the pump for investigation purposes.**

## SERVICE CHECKLIST

**ELECTRICAL PRECAUTIONS-** Before servicing a pump, always shut off the main power breaker and then unplug the pump - making sure you are wearing insulated protective sole shoes and not standing in water. Under flooded conditions, contact your local electric company or a qualified licensed electrician for disconnecting electrical service prior to pump removal.

CONDITION	COMMON CAUSES
A. Pump will not start or run.	Check fuse, low voltage, over load open, open or incorrect wiring, open switch, impeller or seal bound mechanically, defective capacitor or relay when used, motor or wiring shorted.
B. Motor overheats and trips overload or blows fuse.	Incorrect voltage, negative head (discharge open lower than normal) impeller or seal bound mechanically, defective capacitor or relay, motor shorted.
C. Pump starts and stops too often.	Check valve stuck or none installed in long distance line, over load open.
D. Pump operates but delivers little or no water.	Check strainer housing, discharge pipe, or if check valve is used vent hole must be clear. Discharge head exceeds pump capacity. Low or incorrect voltage. Incorrect motor rotation. Capacitor defective. Incoming water containing air or causing air to enter pumping chamber.
E. Drop in head and/or capacity after a period of use.	Increased pipe friction, clogged line or check valve. Abrasive material and adverse chemicals could possibly deteriorate impeller and pump housing. Check line. Remove base and inspect.

**If the above checklist does not uncover the problem, consult the factory - Do not attempt to service or otherwise disassemble pump.**

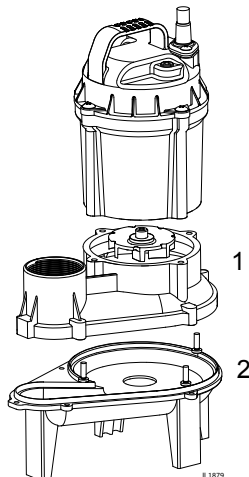

Item	Part #	Description
1	024602	Base/Top
2	024603	Base/Bottom
Not shown	025280	Capacitor